

Plotted By: Aponte, Alan Sheet Set: CYPRESS LANDING CONDOMINIUM PARKING LOT Layout: C2.11 SIGNAGE & MARKING DETAILS March 04, 2025 10:07:52am K:\VTL-Civil\044-Jobs\044203010-Cypress Nook\CAD\Plant\site\01-Cypress Nook\C2.10 SIGNAGE & MARKING DETAILS.dwg
This document, together with the concepts and designs presented herein, as an instrument of service, is intended only for the specific purpose and client for which it was prepared. Reuse of and improper reliance on this document without written authorization and adaptation by Kimley-Horn and Associates, Inc. shall be without liability to Kimley-Horn and Associates, Inc.

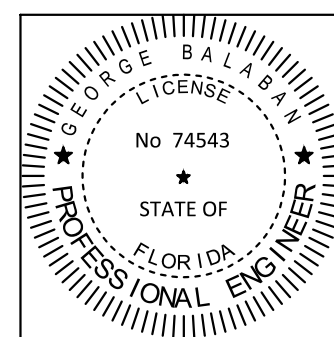
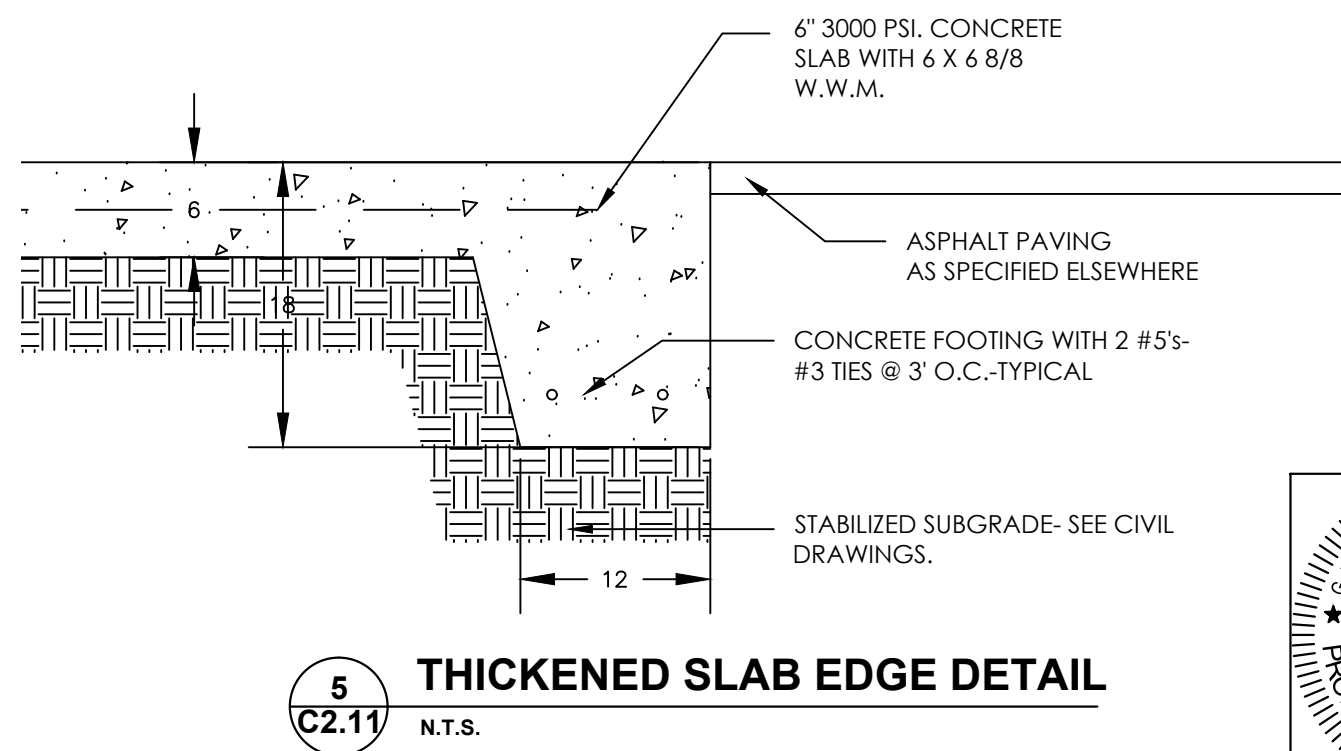
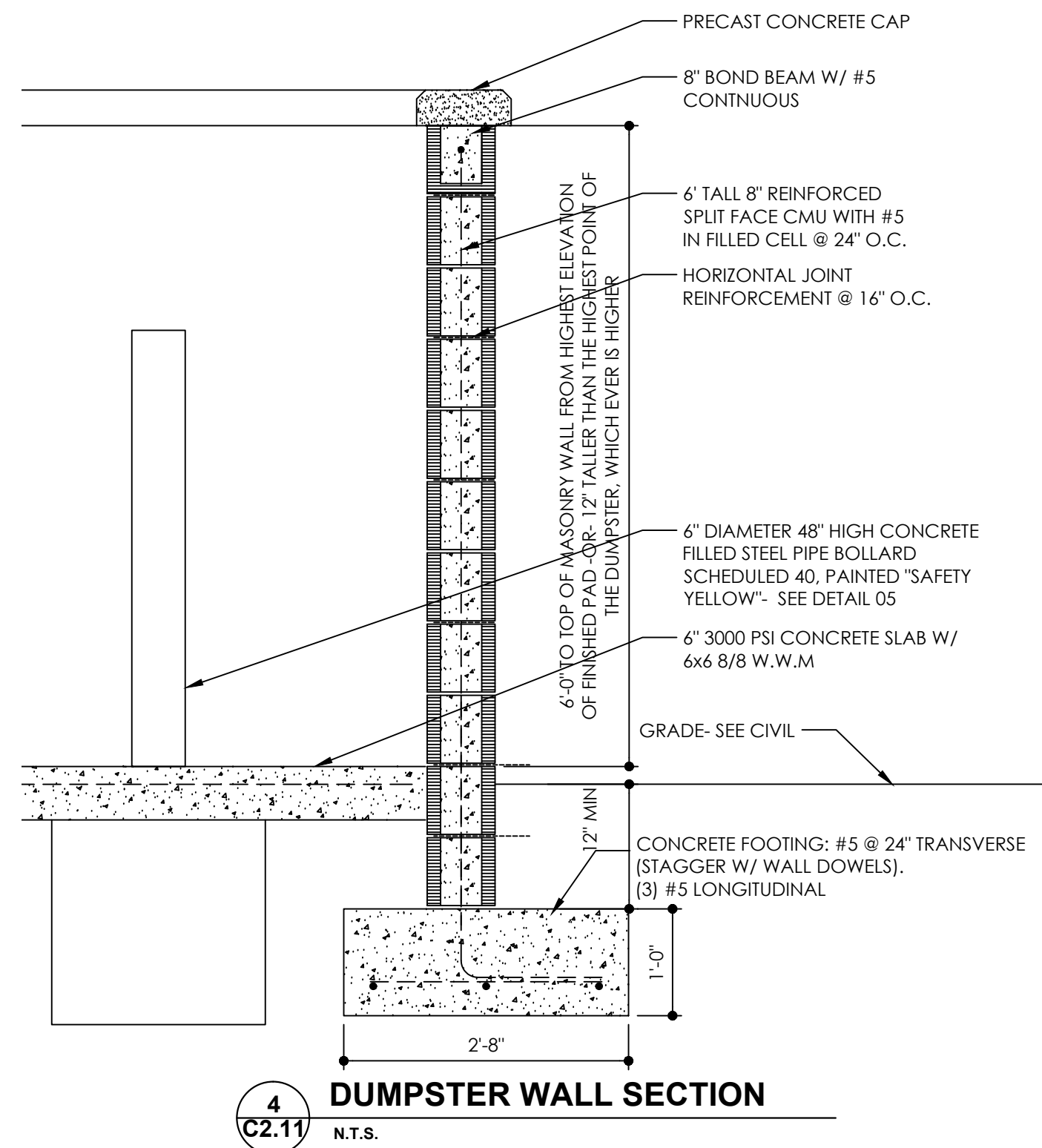
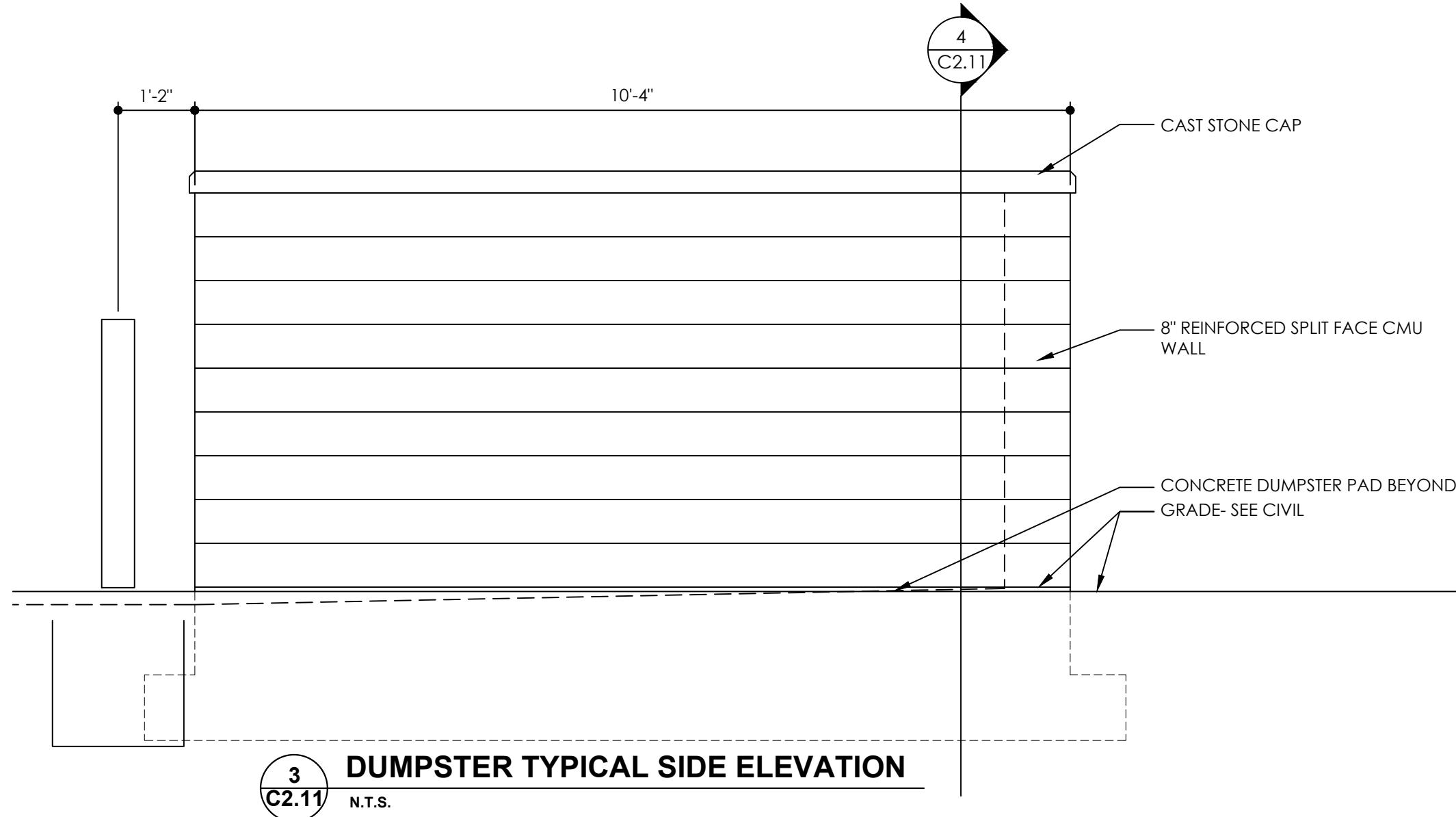
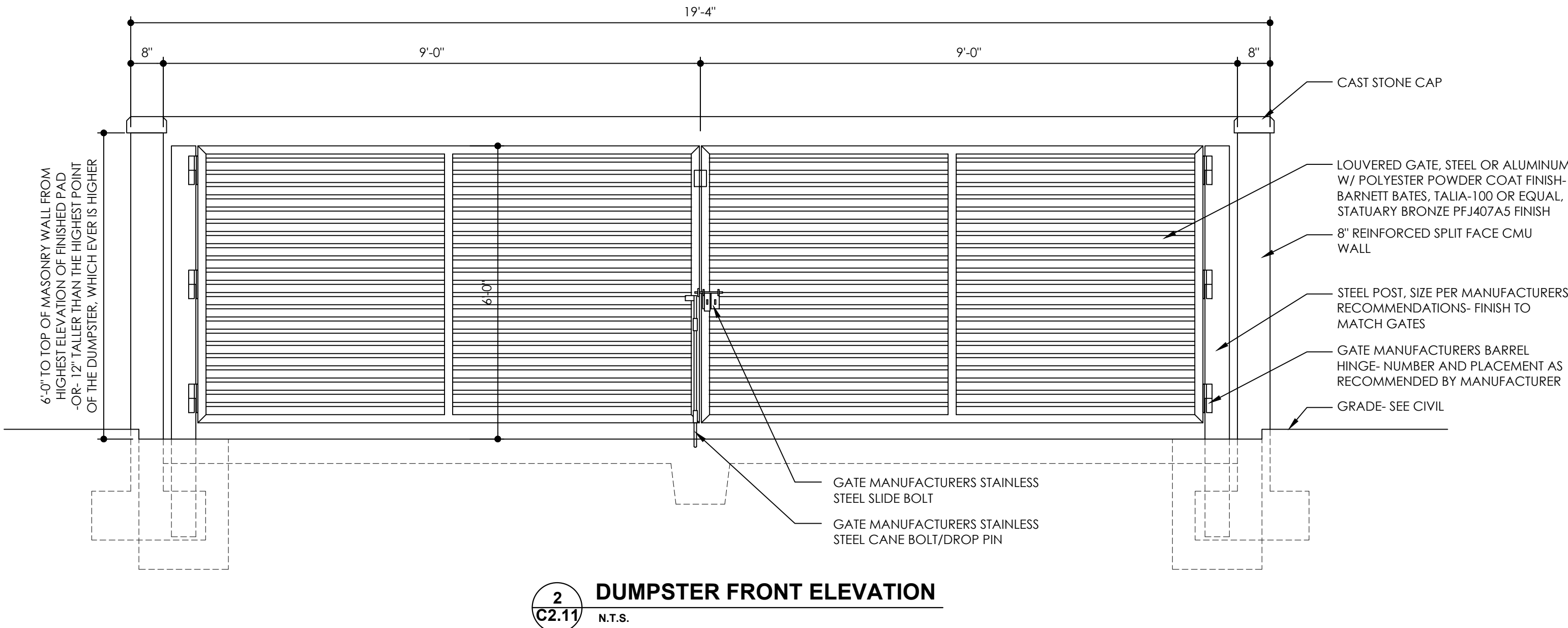
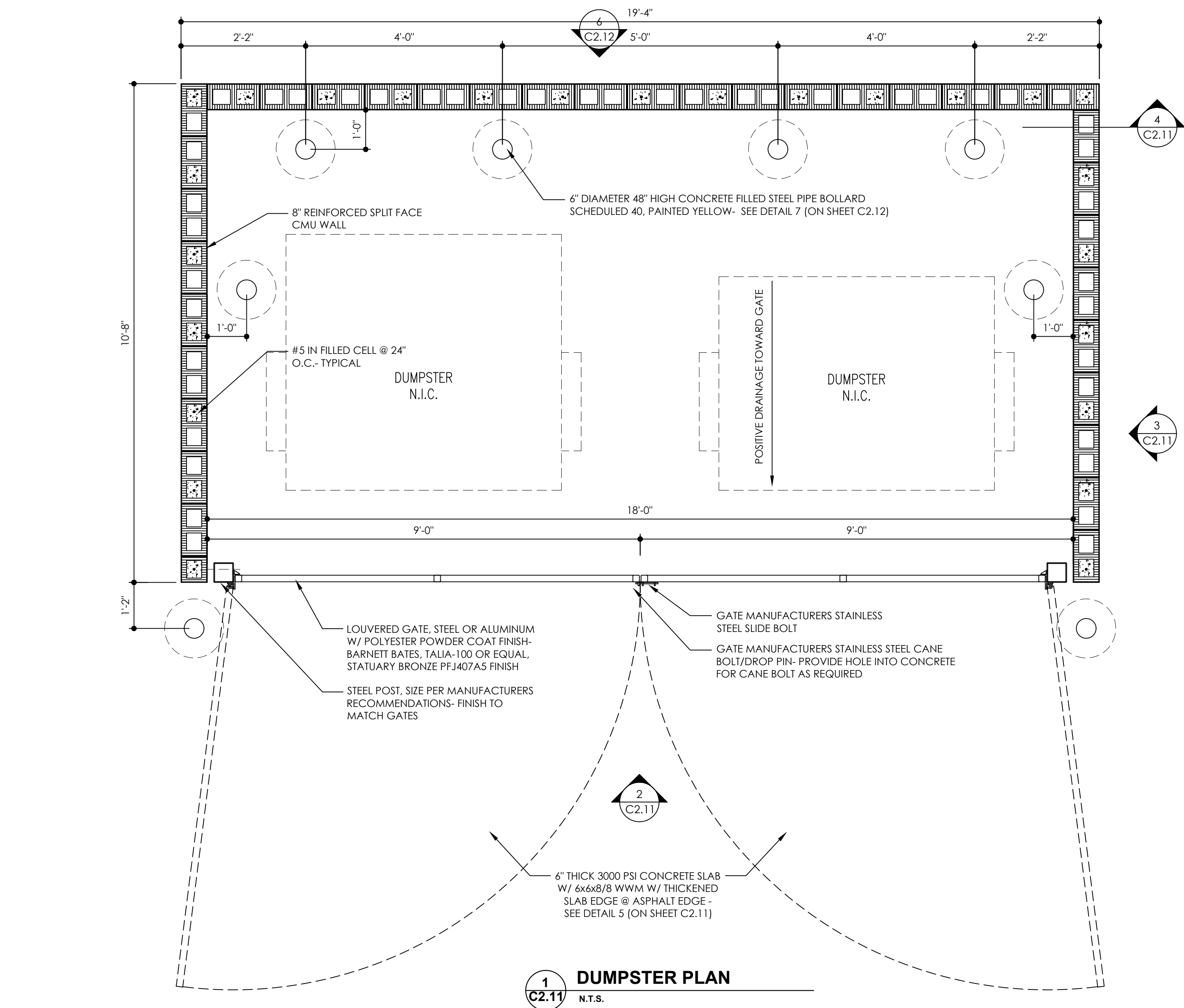

THE ITEM HAS BEEN DIGITALLY SIGNED AND SEALED BY GEORGE BALABAN ON THE DATE ADJACENT TO THE SEAL.
PRINTED COPIES OF THIS DOCUMENT ARE NOT CONSIDERED SIGNED AND SEALED AND THE SIGNATURE MUST BE VERIFIED ON ANY ELECTRONIC COPIES.

PLANS ARE IN NAVD 1988 DATUM
CONVERSION EQUATION IS BELOW:
(NAVD 1988) + 1.58' = (NGVD 1929)

THE PRESENCE OF GROUNDWATER SHOULD BE ANTICIPATED. CONTRACTOR'S BID SHALL INCLUDE CONSIDERATION FOR ADDRESSING THIS ISSUE AND OBTAINING ALL NECESSARY PERMITS.



CYPRESS LANDING CONDOMINIUM PARKING LOT PREPARED FOR CITY OF POMPANO BEACH FL		SHEET NUMBER C2.11	
SIGNAGE & MARKING DETAILS		KIMLEY-HORN & ASSOCIATES, INC. 8201 PETERS ROAD, SUITE 2200, PLANTATION, FL 33324 PHONE: 954-535-5100 FAX: 954-739-2247 WWW.KIMLEY-HORN.COM REGISTRY No. 35106	
LISCENSED PROFESSIONAL GEORGE BALABAN, P.E. DATE FEB 2025 SCALE AS SHOWN DESIGNED BY TVC DRAWN BY TVC CHECKED BY GB DATE 02/12/2025		REVISIONS	
KHA PROJECT 044203010		1 DRC SUBMITTAL	
DATE FEB 2025		DATE 02/12/25	
SCALE AS SHOWN		BY	
DESIGNED BY TVC		DATE	
DRAWN BY TVC		BY	
CHECKED BY GB		DATE	